

FINALS  
1970

P-118

FILED  
9-19-71

142-091-005

FINALS  
1980

P-118

FILMED  
9-1981

Parcel # 142-091-05

APPLICATION FOR PERMIT

- Building
- Grading
- Moving
- Other-Specific
- Demolish

BUILDING INSPECTION DEPARTMENT  
CONTRA COSTA COUNTY  
P.O. Box 749  
Martinez, CA. 94553  
372 2300

Permit # A 65310 A

Date 6/19/78

<b>JOB LOCATION</b> Name <u>W. Creek</u> Lot <u>69</u> No <u>2410</u> Street <u>132 CAFFITO CT.</u> Cross St <u>11 DE</u>		<b>OWNER</b> Name <u>Hauck</u> Address <u>132 Caffito Ct</u> <u>Walnut Creek</u> City <u>Walnut Creek</u> Tel. <u>937-8565</u>		<b>CONTRACTOR</b> Name <u>BEST BUILDERS</u> Address <u>PO 1786</u> City <u>FREMONT, CA.</u> License # <u>239129</u> Tel. <u>657-6111</u>	
<b>SOIL ENG</b> Name _____ Address _____ City _____ License # _____ Tel. _____		<b>ARCH/ENG</b> Name _____ Address _____ City _____ License # _____ Tel. _____		<b>PARK DEDICATION</b> Building Receipt # <u>153268</u> Yes _____ No <u>✓</u>	
<b>EXISTING LOCATION (House Move)</b> Street _____ Cross St _____		<b>Dimensions</b> Ftr area _____ \$ _____ Access _____ \$ _____ _____ \$ _____ _____ \$ _____		<b>Valuation</b> Ftr area _____ \$ _____ Access _____ \$ _____ _____ \$ _____ _____ \$ _____	
<b>LENDER</b> Name _____ Address _____ City _____		<b>Grading</b> Receipt # _____		<b>Moving Estimate</b> of Cost \$ _____	
<b>PUB WORKS</b> CHECKED For Encroachment Ordinance Compliance PUBLIC WORKS DEPARTMENT		<b>Filing Fee</b> Permit \$ _____		<b>Estimated Costs</b> CU Yds. of Excav _____ CU Yds. of Fill _____	
<b>PLAN DEPT</b> Min Setback <u>20'</u> Land Use Dist <u>R-15</u> Census Tract # <u>3383</u> Seismic Zone _____ Min Side Yard <u>5'</u> LUP # _____ Type Use <u>SWIM Pool</u> Yes _____ No <u>✓</u> Agg Min <u>10'</u> Area # _____ Max Height _____ Rear Yard <u>5'</u> No. Stories _____ Park Dist _____ Type Const. New _____ All <u>✓</u> All _____ Move _____ Flood Hazard Prone Yes _____ No <u>✓</u>		<b>Total</b> <u>16' x 38'</u> \$ <u>4500.</u>		<b>Completion Date</b> _____	
<b>INT USE</b> Date Rec'd _____ Eng _____ House _____ Box No. _____ Elec _____ Sanitation _____ No. of Plans _____ Mech _____ Occupancy _____ Type Const. _____ Date Finaled _____ Class _____ Fire Zone _____ By _____		<b>EXPIRATION DATE</b> BUILDING PERMITS (120 DAYS) GRADING PERMIT (180 DAYS) MOVING PERMIT (90 DAYS) MOBILE HOME (6 MONTHS)		<b>Authority</b> CCC 72 & 010 CCC 716 & 1408 CCC 714 & 202 TITLE 25, C.A.C.	
<b>NOTES</b> (Sub Items PLB) _____ ELEC _____ MECH _____ <u>mpp 147-76</u> <u>no heater</u>		<b>UNLESS EXTENSION AUTHORIZED IN WRITING BY THE DEPARTMENT</b> "I Certify that in the performance of the work for which this permit is issued I shall not employ any person in any manner so as to become subject to the Workmen's Compensation Laws of California." by _____ I hereby acknowledge that I have read this application and state that the above is correct and true to comply with all County Ordinances and State Laws regarding _____ Owner/Applicant <u>[Signature]</u>		<b>APPROVED</b> Planning Department <u>[Signature]</u> Date <u>6-19-78</u> By: <u>[Signature]</u> Date <u>6/19/78</u> H.W. Giese, Dir. Building Inspection	

FINALS  
1990

P-118

FILMED  
9-1984

BUILDING INSPECTION DEPARTMENT  
County of Contra Costa  
APPLICATION FOR PERMIT

White Copy - Original  
Candy Copy - File  
Pink Copy - Contractor

Plumb. (B)  
 Elec. (C)  
 Mech. (D)

P.O. Box 749  
Martinez, CA. 94553  
Phone 372-2300

Parcel # 142/091/005 Owner Hauck Date 6-26-77 6-19-78 Receipt Number 153268

Building Permit # 65310 General Contractor Best Bldrs Phone \_\_\_\_\_

Street 132 Cafeto Ct Lot \_\_\_\_\_  
Cross Street \_\_\_\_\_ Subdivision \_\_\_\_\_  
City/Area Wal. Cr.

**PLUMBING CONTRACTOR**

Sq. Feet \_\_\_\_\_  
Name Best Bldrs  
Address P.O. Box 1786 City Fremont  
State Contractor's License No. 739129 Phone 657-6111

WORK TO BE DONE:

<input type="checkbox"/> 1 GAS SYS	<input type="checkbox"/> 5 WATER HEATER VENT
<input type="checkbox"/> 2 SPRINKLER SYS	<input type="checkbox"/> 6 PLUMBING FIXTURES
<input type="checkbox"/> 3 RESTORE SVS	<input type="checkbox"/> 7 MISC
<input type="checkbox"/> 4 MOB. HOME	

**ELECTRICAL CONTRACTOR**

Sq. Feet \_\_\_\_\_  
Name same as above  
Address \_\_\_\_\_ City \_\_\_\_\_  
State Contractor's License No. \_\_\_\_\_ Phone \_\_\_\_\_

WORK TO BE DONE:

<input type="checkbox"/> 1 BR CIR FEEDER	<input type="checkbox"/> 5 POWER POLE	<input type="checkbox"/> 8 WIRING JOB
<input type="checkbox"/> 2 FIXTURE	<input type="checkbox"/> 6 MOB. HOME	<input type="checkbox"/> 9 MISC MACH
<input type="checkbox"/> 3 CHG SVS	<input type="checkbox"/> 7 SVS METER	<input type="checkbox"/> 10 SIGNS
<input type="checkbox"/> 4 RESTORE SVS	<input type="checkbox"/> SVR SWITCH	<input type="checkbox"/> AUPS

GAR REV 1-78

Occupancy pool

**MECHANICAL CONTRACTOR**

Sq. Feet \_\_\_\_\_  
Name \_\_\_\_\_  
Address \_\_\_\_\_ City \_\_\_\_\_  
State Contractor's License No. \_\_\_\_\_ Phone \_\_\_\_\_

WORK TO BE DONE:

<input type="checkbox"/> 1 HEAT APP REGISTER	<input type="checkbox"/> 5 GAS SYS	<input type="checkbox"/> 8 CONVECTOR
<input type="checkbox"/> 2 COOLING APP	<input type="checkbox"/> 6 HOT WATER PANEL	<input type="checkbox"/> 9 FANS
<input type="checkbox"/> 3 HEAT COOL APP	<input type="checkbox"/> 7 FLOOR HER	<input type="checkbox"/> 10 MISC
<input type="checkbox"/> 4 FIRE PLACE		

Return to none

Notes \_\_\_\_\_

Signature  Contractor  Manager  Owner  
V. V. V. V.

Approved Building Inspector  
By R. R. R. R.

Plumbing \$ 15-  
Electrical \$ 22-  
Mech \$ \_\_\_\_\_  
Application \$ \_\_\_\_\_  
Plan Check \$ \_\_\_\_\_  
TOTAL \$ 37-

FINALS  
1980

P-118

FILMED  
9-1981

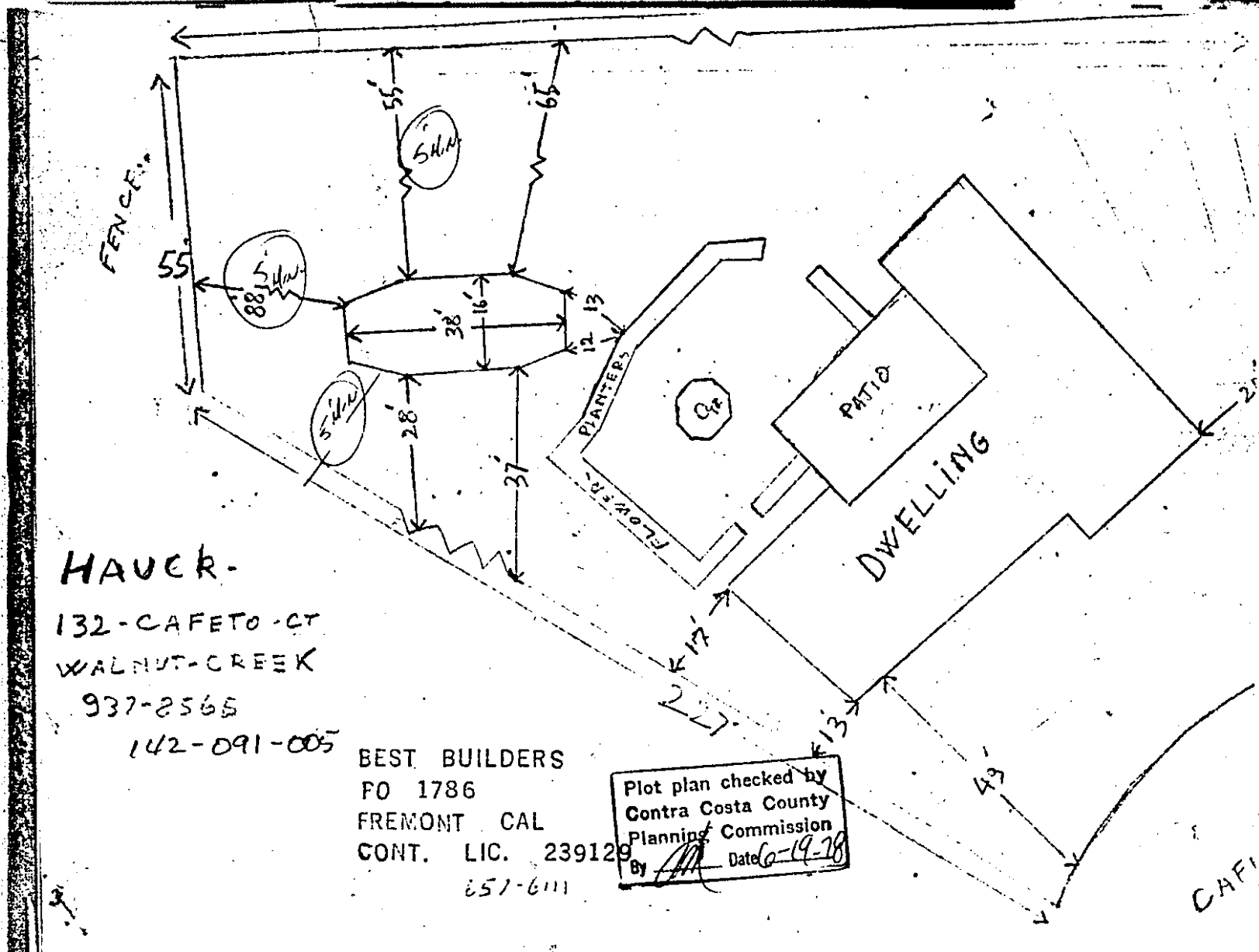

HAUER.

132-CAFETO-CT

WALNUT-CREEK

937-2565

142-091-005

BEST BUILDERS

PO 1786

FREMONT CAL

CONT. LIC. 239129

651-6111

Plot plan checked by  
 Contra Costa County  
 Planning Commission  
 By *[Signature]* Date 6-19-78

CAFI

POOR QUALITY

FINALS  
1970

P-118

FILMED  
9-1981

LANG ENGINEER YG  
2020 Pioneer Ct., Suite #2  
SAN MATEO, CALIFORNIA 94403  
(415) 349-4339  
9 FIRST STREET, SAN FRANCISCO  
(415) 593-4923

SHEET NO. 1 OF 3  
CALCULATED BY: DATE MARCH 11, 1977  
CHECKED BY: DATE  
SCALE FOR GENIE POOLS - FREMONT

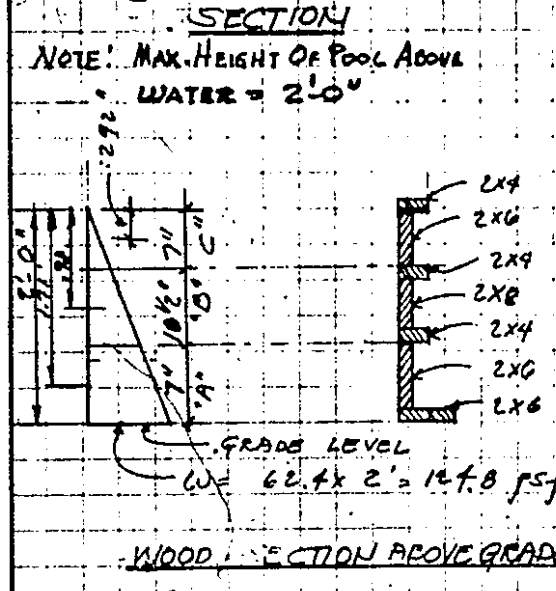
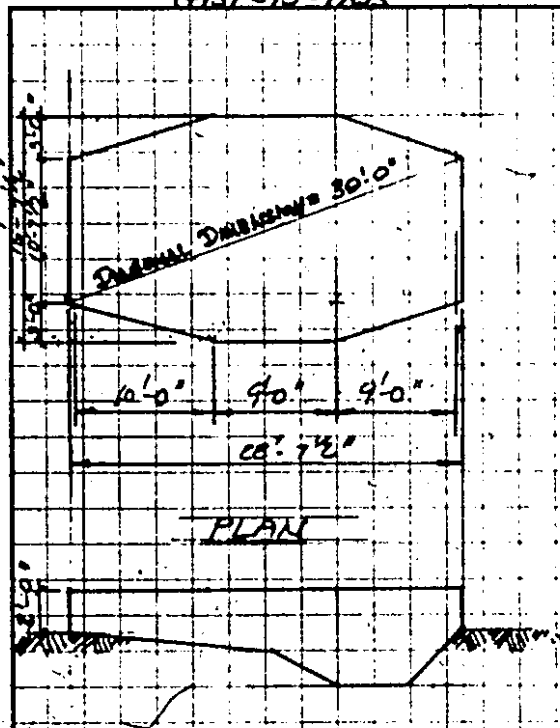

SECTION  
NOTE: MAX. HEIGHT OF POOL ABOVE WATER = 2'0"

SEGMENT "A"

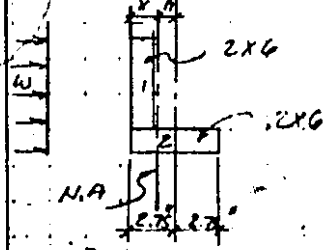

F<sub>A</sub> ALLOW = 1500 psi.

$A_1 = 1.5 \times 5.5 = 8.25 \text{ in}^2$   
 $A_2 = 1.5 \times 5.5 = 8.25 \text{ in}^2$   
 $X = \frac{8.25(1.75) + 8.25(2.75)}{8.25(2)} = 1.75$   
 $h = 2.75 - \bar{x} = 2.75 - 1.75 = 1.0$

$I_{T1} = I_1 + I_2$   
 $I_1 = \frac{1}{12}(5.5)(1.5)^3 = 1.55 \text{ in}^4$   
 $I_2 = \frac{1}{12}(1.5)(5.5)^3 = 20.8 \text{ in}^4$   
 $I = (0.7854)(1.0)^4 = 16.5 \text{ in}^4$

$I_{TOTAL} = 1.55 + 20.8 + 16.5 = 38.85 \text{ in}^4$   
 $W = 62.4 \text{ pcf} \times 1.71' \times \frac{7}{12} = 62.24 \text{ #/ft}^2$

LENGTH OF THE SEGMENT = 9.71'  
 $M = \frac{1}{8} \times 62.24 \times 9.71^2 = 733.4 \text{ #ft}^2$

$S = \frac{I_{TL}}{C} = \frac{38.85}{3.75} = 10.36 \text{ in}^3$

$M = \frac{733.4 \times 12}{10.36} = 858 \text{ psi} < 1500 \text{ psi C.K.}$

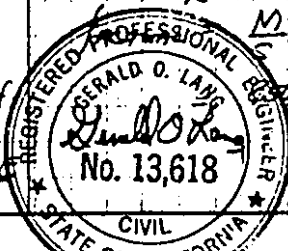

POOR QUALITY

FINALS  
1980

P-118

FILMED  
9-1981

LANG ENGINEER 'IG  
2020 Pioneer Ct. Suite #2  
SAN MATEO, CALIFORNIA 94403  
(415) 348-4332  
9 FIRST STREET, SAN FRANCISCO  
(415) 543-4903

SHEET NO. 2 OF 3  
CALCULATED BY \_\_\_\_\_ DATE MARCH 11, 1977  
CHECKED BY \_\_\_\_\_ DATE \_\_\_\_\_  
SCALE FOR GENIE POOLS - FERMONT

**SEGMENT 'B'**

FL ALLOW = 1500 PSI

$A_1 = 1.50 \times 5.5 = 8.25$   
 $A_2 = 5.25$   
 $A_3 = 1.5 \times 7.5 = 11.25$

$\bar{X} = \frac{5.25(1.75) + 5.25(1.75) + 11.25(7.5)}{(5.25 + 5.25 + 11.25)(7.5)}$   
 $\bar{X} = 1.23"$

$I_1 = I_2 = \frac{1}{12}(1.5)(3.5)^3 = 5.36 \text{ in}^4$

$I_3 = \frac{1}{12}(7.5)(1.5)^3 = 2.10 \text{ in}^4$

$I_0 = 5.36 + 5.36 + 2.10 = 12.82 \text{ in}^4$

$I_T = 12.82 + (5.25 + 5.25 + 11.25)(5.5)^2$   
 $= 24.13 \text{ in}^4$

$C = 3.5 - 1.23 = 2.27"$

$S = \frac{I}{C} = \frac{24.13}{2.27} = 10.63 \text{ in}^3$

$W = 62.4 \times 9.8 \times \frac{10.5^2}{17} = 33.5 \text{ #/ft}$

$M = \frac{1}{8} \times 33.5 \times (9.7)^2 = 630.5 \text{ #ft}$

factual  $\frac{630.5 \times 12}{10.63} = 712 \text{ psi}$   
 $< 1500 \text{ OK}$

**METAL CONNECTION @ JOINT:**  
**PLAN CHECK ITEM 2, #3**

**CORRECTIONS**

MAX. PRESSURE AT BOTTOM  
 $= 62.4 \times 2 = 125 \text{ psf}$   
 $T = 125 \times 15 = 1875 \text{ #/ft}$

SPACING OF STRAP CONNECTION  
 $= 7" \text{ O.C.}$

T PER CONN. =  $1875 \left(\frac{7}{12}\right) = 1094 \text{ #}$

ASSUME TENSION PARALLEL TO GRAIN FOR 2- $\frac{3}{8}"$  M.D.  
 1- $\frac{3}{8}"$  BOLT IN DOUBLE  
 SHEAR PARALLEL TO GRAIN FOR  $1\frac{1}{2}"$  THICK WOOD PER UBC1973  
 $= 670(1.25)(.9)(.75) = 565 \text{ #}$   
 $\therefore 2-\frac{3}{8}" \text{ M.D.} = 2(565) = 1130 \text{ #}$   
 ACTUAL T =  $1094 \text{ #} < 1130 \text{ #}$  OK  
 MIN. END DISTANCE =  $7 \left(\frac{3}{8}\right) = 2.6" \text{ or } 2\frac{3}{4}"$

ALUM. STRAP  $10' \times 2" \times \frac{1}{8}"$

ALUM. STRAP:  $P = 1094 \text{ #}$   
 $f_t = \frac{1094}{1.25 \times 1.25} = 7,000 \text{ psi}$   
 $< 15,000 \text{ psi}$   
 O.K.

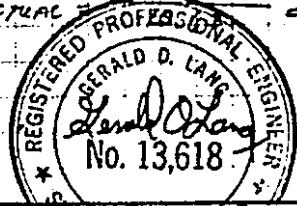

POOR QUALITY

FINALS  
1980

P-118

FILMED  
9/1981

LANG ENGINEER YG  
2020 Pioneer Ct. Suite #2  
SAN MATEO, CALIFORNIA 94403.  
(415) 349-4339  
9 FIRST STREET, SAN FRANCISCO  
(415) 543-4763

SHEET NO. 3 OF 3  
CALCULATED BY G.D.L. DATE MARCH 11, 1977  
CHECKED BY DATE  
SCALE FOR GENIE POOLS - FREMONT

**SHEAR FORCES @ SEGMENT JOINTS:**

VERTICAL 2X6 ONLY:  
N.A. @ 0.75" FROM LEFT  
SIDE OF MEMBER:  
DISTANCE FROM 5.5 TO TOP  
OF UPPERMOST SEGMENT =  
 $2.75 + 17.5 = 20.25 \text{ in.}$   
 $= 1.67$   
UNIT HORIZ. SHEAR,  $H = \frac{V \cdot Q}{I \cdot t}$   
 $Q = 5.5 \times \frac{1.5}{2} \times \frac{4.5}{4} = 1.55 \text{ in.}^2$   
 $t = 5.5 \text{ in.}$   
 $I = \frac{1}{12} \times 5.5 \times 1.5^3 = 1.55 \text{ in.}^4$   
 $W = 62.4 \text{ pcf} \times 1.67 = 105.5 \text{ psf.}$   
 $W = 105.5 \times 5.5 \text{ in.} = 98.4 \text{ #/in.}$   
 $V = 49.9 \times 10 \times \frac{1}{2} = 242 \text{ #}$   
 $H = \frac{(242 \times 98.4 \text{ LBS-IN.})}{(1.55 \times 5.5) \text{ IN.}^2}$   
 $= 44.0 \text{ psf.}$   
SHEAR @ JOINT. PGT. 2X6 VERT.  
& 2X6 HORIZ. (@ BOTTOM) =  
 $44.0 \times 1.5 \times 5.5 = 363.0 \text{ #}$   
 $V = \frac{363}{10} = 36.3 \text{ #/in.}$

USING 16d NAILS, SAME  
LATERAL FORCE @ EA. NAIL =  
107 #.  
SPACING NAILS @ 2'-6" O.C.,  
F EA. NAIL =  $36.3 \times 2.5'$   
 $= 90.75 \text{ #}$   
USE 16d NAILS @ 2'-6" O.C.

CONSIDER 2X6 HORIZ.:  
 $Q = 1.5 \times 2.75 \times 1.375 = 5.67 \text{ in.}^2$   
 $t = 1.5 \text{ in.}$   
 $I = \frac{1}{12} (1.5) (5.5)^3 = 20.8 \text{ in.}^4$   
 $W = 62.4 \times 1.98 = 123.6 \text{ psf.}$   
 $W = 123.6 \times 1.5 \text{ in.} = 15.15 \text{ #/in.}$   
 $V = 15.15 \times 10 \times \frac{1}{2} = 77.25 \text{ #}$   
 $H = \frac{77.25 \times 5.67}{20.8 \times 1.5} = 14 \text{ psf.}$   
 $P = 14 \times 1.5 \times 5.5 = 115.5 \text{ #}$   
 $V = \frac{115.5}{10} = 11.6 \text{ #/in.}$   
16d NAILS @ 2'-6" MIN.

USE SAME SIZE & SPACING  
FOR ALL SEGMENT JOINTS.

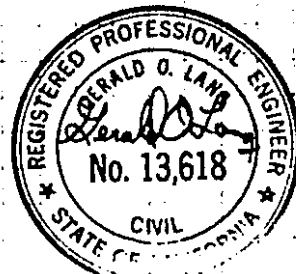

POOR QUALITY

MPP 147-76

Parcel Number <b>142-091-05</b>		Owner's Name <b>Hauck</b>		Location <b>Walnut Creek</b>													
Permit Number <b>65310</b>		General Contractor <b>Best Builders</b>		Subdivision <b>2410</b> Lot <b>69</b>													
Date Received <b>6-19-78</b>		Occupancy		Land Use Dist. <b>R-15</b>													
Zoning and Building Clearances		<table border="1"> <tr> <td>F</td><td>S</td><td>S</td><td>R</td> </tr> <tr> <td>10</td><td>5</td><td>5</td><td>5</td> </tr> <tr> <td>F</td><td>S</td><td>S</td><td>R</td> </tr> </table>		F	S	S	R	10	5	5	5	F	S	S	R	Street <b>132 Capeto Ct</b> Cross Street <b>Capeto Dr.</b>	
F	S	S	R														
10	5	5	5														
F	S	S	R														
Valuation <b>\$4500<sup>00</sup>/<sub>54</sub></b>		Pool <b>153268</b> 6-26-78 <b>#153268</b>															
Footings		Plumbing Contractor <b>Best Builders</b> Fee <b>1500</b> Electrical Contractor <b>Best Builders</b> Fee <b>200</b>		Fixture Contractor Fee Heat & Vent. Contractor Fee Rad. Ht. Contractor Fee Power Pole													
Slabs		Ground Pibg. Rgh. Rough Gas Rough Wiring		Fixtures Heat & Vent. Rough Rough Gas Rad. Ht. Rough Fee													
Slabs		Temp. Gas Service <b>FINAL</b> Temp. Service <b>FINAL</b>		Heat & Vent. <b>FINAL</b> Radiant Heat <b>FINAL</b>													
Frame		Invoice No. _____ Invoice Amount _____ Invoice No. _____ Invoice Amount _____		Invoice No. _____ Invoice Amount _____ Invoice No. _____ Invoice Amount _____													
Lath		Warrant No. _____ Warrant No. _____		Warrant No. _____ Warrant No. _____													
Masonry		<b>6-27-78 pool letter sent</b>		Final Building <b>Expired</b> DATE _____ INITIAL _____													
Fireplace		<b>JUL 1 - 1980 No refund allowed - over 1 year old #16</b>		<b>6-30-80</b> <b>QUIKE</b>													
Water Pressure lbs.																	
Survey #																	
				GRADING PERMIT NO. _____													
				FINAL CHECK _____ DATE _____													
<b>POOL FENCING - REQUIREMENTS</b> APPROVED CONTROL GRANTED BY _____ ONE OF THE ABOVE CONDITIONS MUST BE MET BEFORE FINAL																	